

- Chiave inclusa
- Key included
- Schluessel inbegriffen

Cod. MT	Mandrino Spindle Spindel	I	RPM	Coppia Max Max Torque Max Drehmoment	Reversibile lato mandrino/contromandrino Reversible sub/main spindle side Umkehrbare Spindel-seite/ Gegenspindel-seite	Lubrificazione int. Coolant through Innenkuehlung	Lubrificazione est. Ext. coolant Aussenkuehlung	A	A1	B	D	L	CHIAVI NON INCLUDE Keys not included Schluessel nicht einbegriffen	
													CHSTER20	CHUB32
BGL1010120	ER20	1:1	6000	25Nm	X	-	X	77.16	-	41.5	-	-	CHSTER20	CHUB32
BGL1010220	ER20	1:1	6000	25Nm	X	P=70bar	X	77.16	-	51.5	-	-	CHSTER20	CHUB32
BGL1010516	Ø16x17	1:1	6000	25Nm	X	-	X	-	57	41.5	16	17	CH_VTCROCE_M08	CHUB32

**BIGLIA**  
 MOD: B436/438 - BMX 45Y2  
 MODULO MOTORIZZATO ASSIALE H=70mm  
 Axial driven tool H=70mm  
 Axial angetriebenes Werkzeug H=70mm

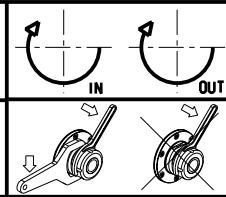

**M.T. srl**  
 Via Casino Albini 480  
 Tel. 0541/956034-957884  
 Fax 0541/956341  
 47842 S. GIOVANNI IN M. (RN)  
 e-mail: mtma@mtmarchetti.com  
 http://www.mtmarchetti.com



PAGINA BGL150-2-10

Subject to change without notice.