

-LA FUNZIONE DI POLIGONATURA/DENTATURA DEVE ESSERE INSTALLATA SULLA MACCHINA
 -POLYGON CUTTING/GEAR HOBBING FUNCTION MUST BE INSTALLED ON THE MACHINE
 -DIE FUNKTION FÜR POLYGON-BZW. VERZÄHNUNGSFRÄSEN MUSS AUF DER MASCHINE FREIGESCHALTET WERDEN

Cod. MT	i	RPM max	Coppia Max Max Torque Max Drehmoment	Lubrificazione est. Ext. coolant Aussenkuehlung	D (mm)	CHIAVI INCLUSE Keys included Schluessel inbegriffen					
						CHUB24	CHUB13	CHESL04	CHESL07	CHESL08	
BGL0011108	1:1	6000	50Nm	X	8	CHUB24	CHUB13	CHESL04	CHESL07	CHESL08	
BGL0011110	1:1	6000	50Nm	X	10	CHUB24	CHUB17	CHUB13	CHESL07	CHESL08	CHESL05
BGL0011113	1:1	6000	50Nm	X	13	CHUB24	CHUB19	CHUB13	CHESL07	CHESL08	
BGL0011116	1:1	6000	50Nm	X	16	CHUB24	CHUB13	CHESL08	CHESL07		

BIGLIA
 MOD: B301/445/470/501(Y-S)/510/545/550/565/620/650/658/1200/446/465/745/765

MODULO MOTORIZZATO PORTACREATORE RADIALE
 Radial driven gear hobber
 Radial angetriebenes Zahnradwaelzfraes-Werkzeug

Subject to change without notice.

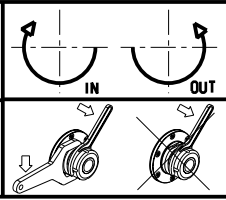

M.T. srl
 Via Casino Albini 480
 Tel. 0541/956034-957884
 Fax 0541/956341
 47842 S. GIOVANNI IN M. (RN)
 e-mail: mtma@mtmarchetti.com
 http://www.mtmarchetti.com



PAGINA BGL340-1-30