

- Chiave inclusa
- Key included
- Schlüssel inbegriffen

Cod. MT	Mandrino Spindle Spindel	I	RPM	Coppia Max Max Torque Max Drehmoment	Lubrificazione int. Coolant through Innenkuhlung	Lubrificazione est. Ext. coolant Aussenkuhlung	H	Tipo Torretta Turret Type Revolver Typ	CHIAVI NON INCLUSE Keys not included Schlüssel nicht einbegriffen	
HAS0297132	ERA32	1:2	12000	45Nm	-	X	130.25	HYBRID 12 TURRET	CHUB30	CHTAER32ZC ■ OKU0650004 ■
HAS0297232	ERA32	1:2	12000	45Nm	P=70bar	X	130.25	HYBRID 12 TURRET	CHUB30	CHTAER32ZC ■ OKU0650004 ■
HAS0317132	ERA32	1:2	12000	45Nm	-	X	117.55	VDI STANDARD	CHUB30	CHTAER32ZC ■ OKU0650004 ■
HAS0317232	ERA32	1:2	12000	45Nm	P=70bar	X	117.55	VDI STANDARD	CHUB30	CHTAER32ZC ■ OKU0650004 ■

HAAS  
MOD: SL40 - ST40/45

MODULO MOTORIZZATO ASSIALE MOLTIPLICATO I=1:2 DISASSATO 42mm VDI40  
Axial geared-up I=1:2 driven tool re-directed by 42mm VDI40  
Axial angetriebenes Werkzeug uebersetzt I=1:2 achsversetzt um 42mm VDI40

Subject to change without notice.

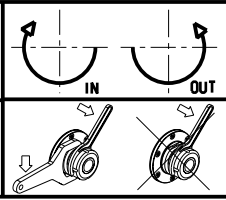

**M.T. srl**  
Via Casino Albini 480  
Tel. 0541/956034-957884  
Fax 0541/956341  
47842 S. GIOVANNI IN M. (RN)  
e-mail: mtma@mtmarchetti.com  
http://www.mtmarchetti.com



HAS160-2-20