

SAU0990232

- Chiave inclusa
- Key included
- Schlusssel inbegriffen

Cod. MT	Mandrino Spindle Spindel	I	RPM	Coppia Max Max Torque Max Drehmoment	Lubrificazione int. Coolant through Innenkuehlung	Lubrificazione est. Ext. coolant Ausseenkuehlung	A	A1	CHIAVI NON INCLUSE Keys not included Schlusssel nicht einbegriffen	
202SAU_A32_40D00	ER32	1:1	4000	70Nm	-	X	107.26	-	CHUB41	CHSTER32
SAU0990232	ER32	1:1	4000	70Nm	P=70bar	X	112.96	-	OKU0650004	CHSTER32
SAU0460420	WELDON 20	1:1	4000	70Nm	-	X	-	97.3	-	-

HYUNDAI-W IA (KIA)
 MOD: SKT15LM/LMS - L150LMSA - SKT21LM/LMS - L210LMSA

MODULO MOTORIZZATO ASSIALE VDI40 DIN 5482
 Axial driven tool VDI40 DIN 5482
 Axial angetriebenes Werkzeug VDI40 DIN 5482

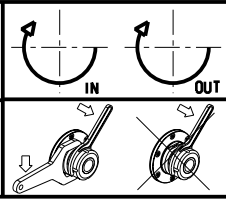

M.T. srl
 Via Casino Albini 480
 Tel. 0541/956034-957884
 Fax 0541/956341
 47842 S. GIOVANNI IN M. (RN)
 e-mail: mtma@mtmarchetti.com
 http://www.mtmarchetti.com



KIA014-1-00

Subject to change without notice.