

- Chiave inclusa
- Key included
- Schluessel inbegriffen

| Cod. MT | Mandrino Spindel Spindel | I | RPM | Coppia Max Max Torque Max Drehmoment | Reversibile lato mandrino/contromandrino Reversible sub/main spindle side Umkehrbare Spindel-seite/ Gegenspindel-seite | Lubr.interna Coolant through Innenkuehlung | Lubr. esterna Ext. coolant Aussenkuehlung | A | A1 | B | CHIAVI NON INCLUDE Keys not included Schluessel nicht einbegriffen | |
|------------|--------------------------------|-----|------|--|---|--|---|-------|-------|----|--|----------|
| | | | | | | | | | | | | |
| DW03200340 | ER40 | 1:1 | 3000 | 210Nm | X | - | X | 140.2 | - | 75 | NZL0010023 | CHSTER40 |
| DW03200440 | ER40 | 1:1 | 3000 | 210Nm | X | P=70bar | X | 140.2 | - | 86 | NZL0010023 | CHSTER40 |
| DW03200350 | ER50 | 1:1 | 3000 | 210Nm | X | - | X | 153.5 | - | 75 | NZL0010023 | CHSTER50 |
| DW03200450 | ER50 | 1:1 | 3000 | 210Nm | X | P=70bar | X | 153.5 | - | 86 | NZL0010023 | CHSTER50 |
| DW03200150 | ERA50 | 1:1 | 3000 | 210Nm | X | - | X | 145.3 | - | 75 | NZL0010023 | CHUB50 |
| DW03200250 | ERA50 | 1:1 | 3000 | 210Nm | X | P=70bar | X | 145.3 | - | 86 | NZL0010023 | CHUB50 |
| DW01390240 | Weldon 40 | 1:1 | 3000 | 210Nm | X | - | X | - | 175.5 | 75 | - | - |
| DW01390140 | Weldon 40 | 1:1 | 3000 | 210Nm | X | P=70bar | X | - | 175.5 | 86 | - | - |

HYUNDAI-W IA (KIA)
 MOD: SKT600LM - L600LMA - SKT700LM - L700LMA - L800LMA - KL7000/8000LY

MODULO MOTORIZZATO ASSIALE H=85mm
 Axial driven tool H=85mm
 Axial angetriebenes Werkzeug H=85mm

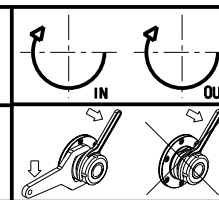

M.T. srl
 Via Casino Albini 480
 Tel. 0541/956034-957884
 Fax 0541/956341
 47842 S. GIOVANNI IN M. (RN)
 e-mail: mtma@mtmarchetti.com
 http://www.mtmarchetti.com



Subject to change without notice.