

**CUSCINETTI MAGGIORATI  
PER LAVORAZIONI PESANTI**

Reinforced bearings for heavy machining  
Vergroesserte Lager fuer schwerere Bearbeitungen

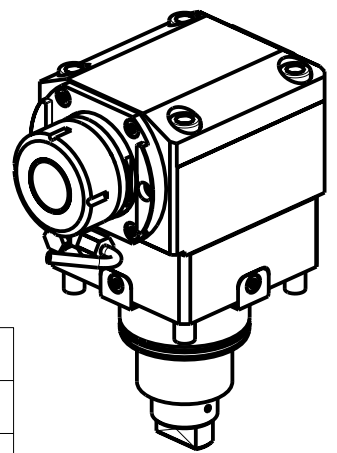

- Chiave inclusa
- Key included
- Schluessel inbegriffen

| Cod. MT     | Mandrino Spindle Spindel | I   | RPM  | Coppia Max Max Torque Max Drehmoment | Reversibile lato mandrino/contromandrino Reversible sub/main spindle side Umkehrbare Spindel-seite/ Gegenspindel-seite | Lubrificazione int. Coolant through Innenkuehlung | Lubrificazione est. Ext. coolant Aussenkuehlung | A     | A1    | A2 | B    | D  | L  | CHIAVI NON INCLUSE<br>Keys not included<br>Schluessel nicht einbegriffen |            |
|-------------|--------------------------|-----|------|--------------------------------------|--|---|---|-------|-------|----|------|----|----|--|------------|
| DW 00650140 | ER40                     | 1:1 | 6000 | 140Nm                                | X  | -   | X   | 109.7 | -     | -  | 64   | -  | -  | CHSTER40   | OKU0430007 |
| DW 00650240 | ER40                     | 1:1 | 6000 | 140Nm                                | X  | P=70bar   | X   | 109.7 | -     | -  | 76.5 | -  | -  | CHSTER40   | OKU0430007 |
| DW 00650725 | WELDON 25                | 1:1 | 6000 | 140Nm                                | X  | -   | X   | -     | 109.5 | -  | 64   | -  | -  | -  | -          |
| DW 00650825 | WELDON 25                | 1:1 | 6000 | 140Nm                                | X  | P=70bar   | X   | -     | 109.5 | -  | 76.5 | -  | -  | -  | -          |
| DW 00650522 | Ø22x19                   | 1:1 | 6000 | 140Nm                                | X  | -   | X   | -     | -     | 89 | 64   | 22 | 19 | CH_VTCROCE_M10   | OKU0430007 |

HYUNDAI-W IA (KIA)

MOD: SKT400M/LMC - L400/500 MA/MC/LMC - LV500RM/LM - LV8500RM/LM - L4000M/LM/MC/LMC - L5100LM/LMC/LY

MODULO MOTORIZZATO ASSIALE MAGGIORATO H=90mm  
Axial reinforced driven tool H=90mm  
Axial angetriebenes Werkzeug vergroessert H=90mm

Subject to change without notice.

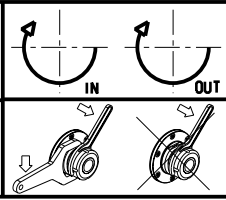

**M.T. srl**  
Via Casino Albini 480  
Tel. 0541/956034-957884  
Fax 0541/956341  
47842 S. GIOVANNI IN M. (RN)  
e-mail: mtma@mtmarchetti.com  
http://www.mtmarchetti.com



KIA170-4-20