

ATTENZIONE: Non si monta su macchine NT3000 SERIE
 # WARNING: This tool can not be mounted on NT3000 SERIES
 # ACHTUNG: Werkzeug darf nicht auf NT3000 SERIEN montiert werden

- Chiave inclusa
- Key included
- Schluessel inbegriffen

Cod. MT	Mandrino Spindel	I	RPM	Coppia Max Max Torque Max Drehmoment	Reversibile lato mandrino/contromandrino Reversible sub/main spindle side Umkehrbare Spindel-seite/Gegenspindel-seite	Lubr.interna Coolant through Innenkuehlung	Lubr.esterna Ext. coolant Aussenkuehlung	A	A1	D	L	E	CHIAVI NON INCLUDE Keys not included Schluessel nicht einbegriffen	
													CHUB46	CHUB27
MNZ0060125	ER A 25	2:1	3000	60Nm	X	-	X	87.53	-	-	-	12	CHUB46	CHUB27
MNZ0060132	ER A 32	2:1	3000	60Nm	X	-	X	95.03	-	-	-	12	CHUB46	CHUB32
MNZ0060525	ER A 25	2:1	3000	60Nm	X	P=70bar	X	87.53	-	-	-	22	CHUB46	CHUB27
MNZ0060532	ER A 32	2:1	3000	60Nm	X	P=70bar	X	95.03	-	-	-	22	CHUB46	CHUB32
MNZ0060116	Ø16x17	2:1	3000	60Nm	X	-	X	-	75.5	16	17	12	CHUB46	CH_VTCROCE_M08 *
MNZ0060122	Ø22x19	2:1	3000	60Nm	X	-	X	-	75.5	22	19	12	CHUB46	CH_VTCROCE_M10 *
MNZ0060119	Ø3/4"x3/4"	2:1	3000	60Nm	X	-	X	-	75.5	3/4"	3/4"	12	CHUB46	CH_VTCROCE_M08 *

DMG-MORI
 NZ1500/2000 - NZX1500/2000 - NZX2500 (BMT40) - NT3100/3150/3200 - NL1500/2000/2500 20 STAZ. - NLX1500/2000/2500 20 STAZ. - NT1000/2000
 NTX1000/2000 - NTX1000/2000/2500/3000 2ND GEN. 12ST. - DURATURN 2050MC/2550MC - NRX2000 - ALC/ALX1500/2000/2500 (BMT40) - ECOTURN 450 (BMT40)

MODULO MOTORIZZATO RADIALE RIDOTTO I=2:1 DISASSATO IN Z 90mm
 Radial geared-down I=2:1 driven tool re-directed in Z by 90mm
 Radial angetriebenes Werkzeug untersetzt I=2:1 achsversetzt in Z um 90mm

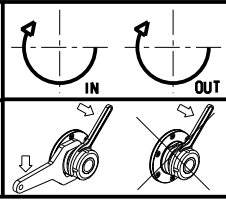

M.T. srl
 Via Casino Albini 480
 Tel. 0541/956034-957884
 Fax 0541/956341
 47842 S. GIOVANNI IN M. (RN)
 e-mail: mtma@mtmarchetti.com
 http://www.mtmarchetti.com

MNZ030-1-20

Subject to change without notice.