

OKU1780232

OKU1780240

- Chiave inclusa
- Key included
- Schluessel inbegriffen

Cod. MT	Mandrino Spindle Spindel	I	RPM	Coppia Max Max Torque Max Drehmoment	Lubrificazione est. Ext. coolant Aussenkuehlung	Lubrificazione int. Coolant through Innenkuehlung	A	A1	CHIAVI NON INCLUDE Keys not included Schluessel nicht einbegriffen	
									CHUB41	CHSTER32
1220KU_A32_40B00	ER32	1:1	4000	70Nm	X	-	107.3	-	CHUB41	CHSTER32
OKU1780232	ER32	1:1	4000	70Nm	X	P=70bar	112.96	-	OKU0650004	CHSTER32
OKU1780240	ER40	1:1	4000	70Nm	X	P=70bar	115.96	-	OKU0650004	CHSTER40
1220KU_A32_40B10	WELDON 8	1:1	4000	70Nm	X	-	-	88.1	-	-
1220KU_A32_40B12	WELDON 12	1:1	4000	70Nm	X	-	-	92.6	-	-
1220KU_A32_40B14	WELDON 16	1:1	4000	70Nm	X	-	-	95.1	-	-

**OKUMA**  
MOD: LB15/300 - LT15/300 - LR15 - LU15M - LU300M - GENOS L300M - GENOS L3000e M/MY (VD140)  
MACTURN 250/350/550 - ES L10M

MODULO MOTORIZZATO ASSIALE VD140  
Axial driven tool VD140  
Axial angetriebenes Werkzeug VD140

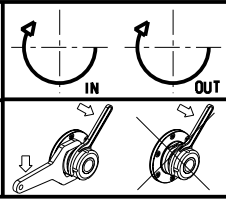

**M.T. srl**  
Via Casino Albini 480  
Tel. 0541/956034-957884  
Fax 0541/956341  
47842 S. GIOVANNI IN M. (RN)  
e-mail: mtma@mtmarchetti.com  
http://www.mtmarchetti.com



OKU150-2-00

Subject to change without notice.