

- Chiave inclusa
- Key included
- Schlüssel inbegriffen

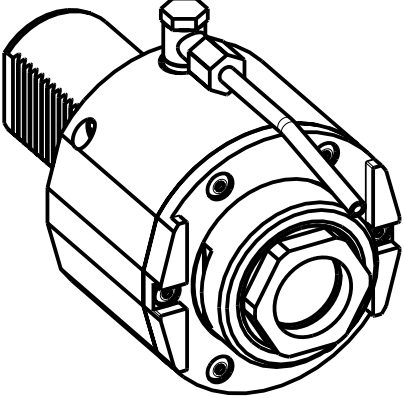

| Cod. MT    | Mandrino Spindle Spindel | I   | RPM  | Coppia Max Max Torque Max Drehmoment | Lubrificazione int. Coolant through Innenkuehlung | Lubrificazione est. Exl. coolant Aussenkuehlung | CHIAVI NON INCLUSE<br>Keys not included<br>Schlüssel nicht einbegriffen |              |
|------------|--------------------------|-----|------|--------------------------------------|---|---|---|--------------|
| SAU0880140 | ERA40                    | 1:1 | 4000 | 100Nm                                | -   | X   | CHUB42  | OKU0430007 * |
| SAU0880240 | ERA40                    | 1:1 | 4000 | 100Nm                                | P=30bar   | X   | CHUB42  | OKU0430007 * |

SAUTER  
VDI 50

MODULO MOTORIZZATO ASSIALE VDI50 DIN 5482  
Axial driven tool VDI50 DIN 5482  
Axial angetriebenes Werkzeug VDI50 DIN 5482

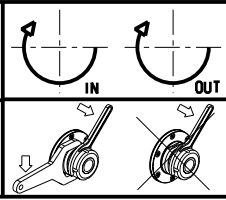

**M.T. srl**  
Via Casino Albini 480  
Tel. 0541/956034-957884  
Fax 0541/956341  
47842 S. GIOVANNI IN M. (RN)  
e-mail: mtma@mtmarchetti.com  
http://www.mtmarchetti.com



SAU014-4-00

Subject to change without notice.