

**ATTENZIONE - ATTENTION - ACHTUNG**

- Per lo smontaggio degli utensili utilizzare sempre la chiave di contrasto come indicato nel manuale d'uso.
- For disassembly of the tools use always the contrast key as mentioned in the user instructions.
- Fuer das Abmontieren der Werkzeuge immer den Gegenschlüssel benutzen wie in der Bedienungsanleitung erwaeht.

**ATTENZIONE - ATTENTION - ACHTUNG**

- VERIFICARE LE MISURE DI INGOMBRO PER POSSIBILE INTERFERENZA SU ALCUNI MODELLI DI MACCHINE
- Please check the overall sizes for possible interferences on some machine models
- Bitte überprüfen sie das ausmass um mögliche interferenzen auf einigen maschinen modellen zu vermeiden

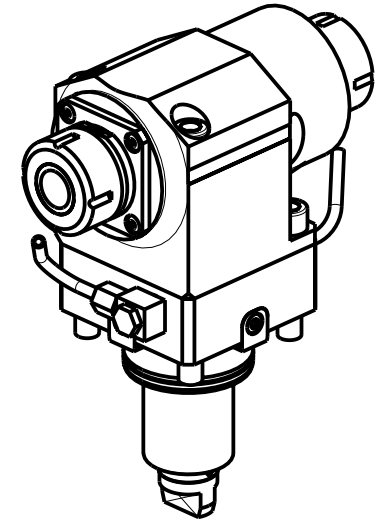
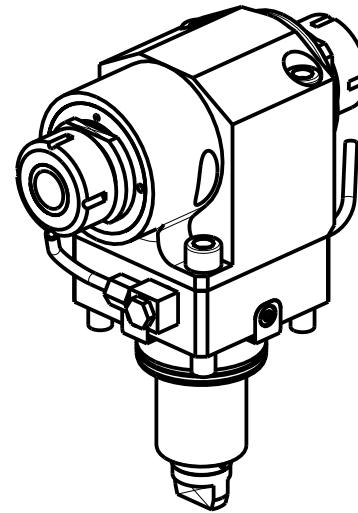
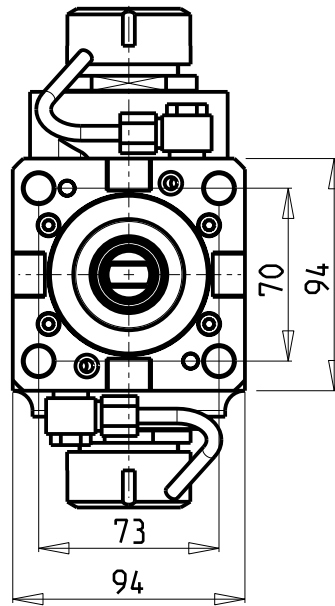
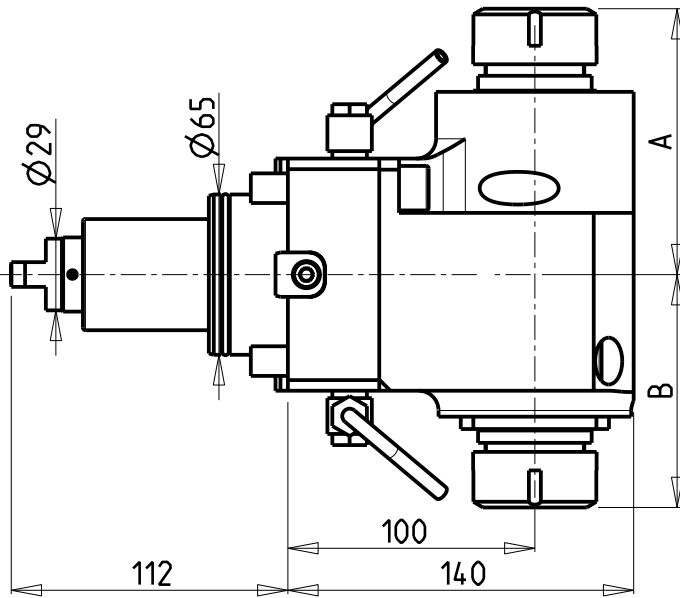

| Cod. MT     | Mandrino Spindle Spindel | I   | RPM  | Coppia Max Max Torque Max Drehmoment | Reversibile lato mandrino/contromandrino Reversible sub/main spindle side Umkehrbare Spindelseite/Gegenspindelseite | Lubrificazione est. Ext. coolant Aussekkuehlung | A      | B     | CHIAVI NON INCLUSE Keys not included Schluessel nicht einbegriffen |        |        |
|-------------|--------------------------|-----|------|--------------------------------------|---|---|--------|-------|--|--------|--------|
|             |                          |     |      |                                      |   |   |        |       | CHSTER32   | CHUB46 |        |
| DW 00070232 | ER32+ER32                | 1:1 | 6000 | 100Nm                                | X   | X   | 107.66 | 94.26 | CHSTER32   | CHUB46 |        |
| DW 00073225 | ERA25+ERA32              | 1:1 | 6000 | 100Nm                                | X   | X   | 106.03 | 81.13 | CHUB27   | CHUB32 | CHUB46 |

YCM  
 MOD: BTX250SY - NT2000/2500 12 STAZIONI  
 MODULO MOTORIZZATO ASSIALE BISPORGENTE H=100mm  
 Axial opposite face twin driven tool H=100mm  
 Axial angetriebenes Werkzeug halb vorspringend H=100mm

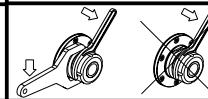

**M.T. srl**  
 Via Casino Albini 480  
 Tel. 0541/956034-957884  
 Fax 0541/956341  
 47842 S. GIOVANNI IN M. (RN)  
 e-mail: mtma@mtmarchetti.com  
 http://www.mtmarchetti.com



YCM240-2-20

Subject to change without notice.

03/2024